

Floor ducts & finishing accessories

Number(s) : 032800/01/02/03/05/06/07/10, 030092/93,
030011/12/13/18/19, 010770/71/72/74, 010690.



CONTENTS	PAGES
1. Range	1 to 3
2. Finishing Accessories	3 to 5
3. Implementation	5
4. Technical characteristics	6
5. Material characteristics	6

1. RANGE

The floor duct distribution system provides:

- distribution, protection and branching of different wires and cables in an electrical installation
- profiles, finishing and routing accessories (end cap, flat angle, junction box, cover joint)
- optimum reliability and safety through compliance with standard NF EN 50085-2-2

For creating a link between a profile, column, mini-column or floor unit.

1.1. Floor duct 50x12 mm Cat. No. 030092

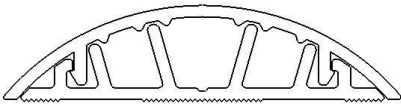

Supplied in lengths of 2 m, packs of 54 m

To be cut with saw (metal type saw) and cutting box (Cat. No. 030698)

Body and cover made solid by snap-fitting (removable using tool, e.g. screwdriver, etc.)

3 compartments

IP 40 IK 07

Colour, grey RAL 7030

1. RANGE (continued)

1.1. Floor duct 50x12 mm Cat. No. 030092 (continued)

Overall dimensions:

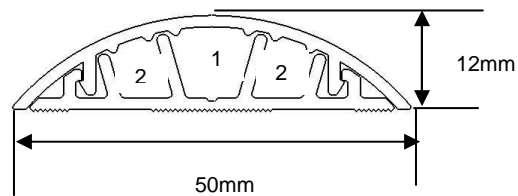

Cabling capacity:

50x12 mm	Useful cross-section mm ² per compartment	Cable Ø Max (mm)
1	70	9
2	40	6
2	40	6

50x12 mm	1.5 mm ²	2.5 mm ²	4 mm ²	6 mm ²	UTP FTP Cat. 6
1	4	3	2	2	1
2	2	1	1	1	0
2	2	1	1	1	0

1. RANGE (continued)

1.2. Floor duct 75x18 mm, Cat. No. 030093

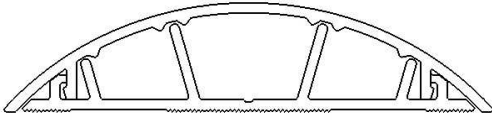

Supplied in lengths of 2m, packs of 36m
To be cut with saw (metal type saw) and cutting box (Cat. No. 030698)
Body and cover made solid by snap-fitting (removable using tool, e.g. screwdriver, etc.)
3 compartments
IP 40 IK 07
Colour, grey RAL 7030

Overall dimensions:

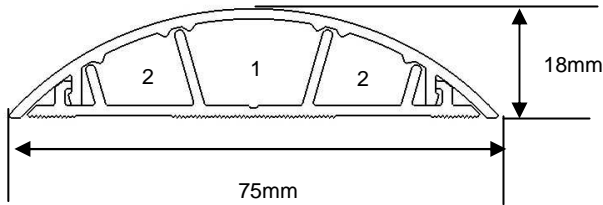

Cabling capacity:

75x18 mm	Useful cross-section mm ² per compartment	Cable Ø Max (mm)
1	210	14
2	120	11
2	120	11

75x18 mm	1.5 mm ²	2.5 mm ²	4 mm ²	6 mm ²	UTP FTP Cat. 6
1	12	9	8	6	4
2	7	5	4	3	2
2	7	5	4	3	2

1. RANGE (continued)

1.3. Floor duct 92x20 mm, Cat. No. 032800

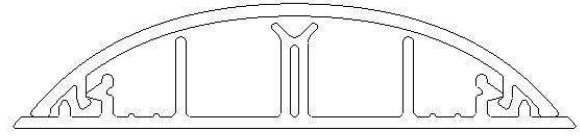

Supplied in lengths of 2m, packs of 20m
Granite cover.
Equipped with two adhesive strips for better hold on floor.
To be cut with saw (metal type saw) and cutting box (Cat. No. 030698)
Body and cover made solid by snap-fitting (removable using tool, e.g. screwdriver, etc.)
4 compartments
IP 40 IK 08
Colour, grey RAL 7016

Overall dimensions:

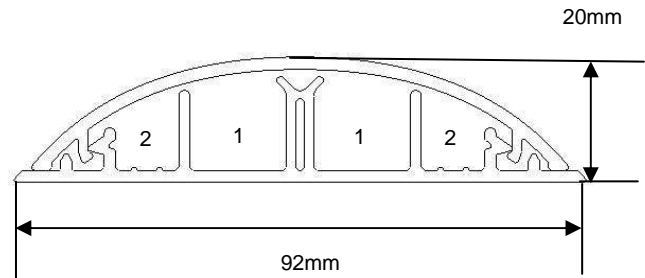

Cabling capacity:

92x20 mm	Useful cross-section mm ² per compartment	Cable Ø Max (mm)
1	210	14.5
1	210	14.5
2	100	9.5
2	100	9.5

92x20 mm	1.5 mm ²	2.5 mm ²	4 mm ²	6 mm ²	UTP FTP Cat. 6
1	12	9	8	6	4
1	12	9	8	6	4
2	6	4	3	2	1
2	6	4	3	2	1

Floor ducts & finishing accessories

Number(s) : 032800/01/02/03/05/06/07/10, 030092/93,
030011/12/13/18/19, 010770/71/72/74, 010690.

2. FINISHING ACCESSORIES

2.1. Flat angle, Cat. Nos 030011/18 and 032802.

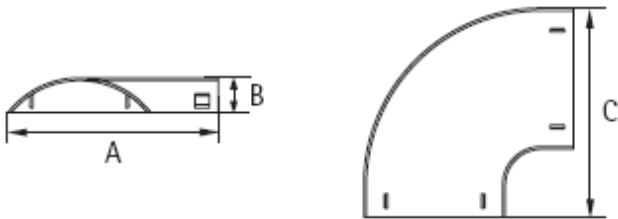

References	For flat angle	Dimensions in mm
030011	50x12 mm	A=53/B=14/C=84
030018	75x18 mm	A=79/B=19/C=116
032802	92x20 mm	A=B=C=

For joining with flat angle two pieces of floor duct of the same cross-section:

- avoids mitre cutting the profile
- compliance with the protection index
- improved styling (cut covered)
- mounting on skirting by snap-fitting
- can be installed after fitting profiles edge-to-edge, the remaining space takes the flat angle's plate

Colour, grey RAL 7030 for Cat. Nos 030011/18

Colour, grey RAL 7016 for Cat. No. 032802

Packs of 10 for Cat. Nos 030011/18, packs of 5 for Cat. No. 032802

For mounting with floor ducts 50x12 or 75x18mm

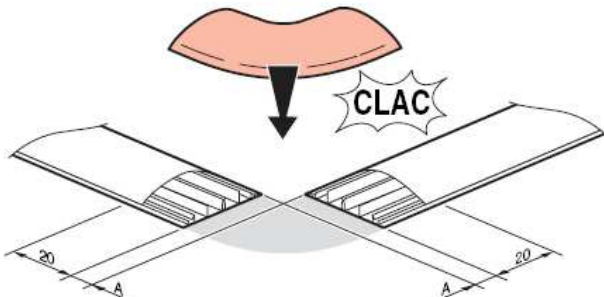

	A
	10
	20

For mounting with floor ducts 92x20mm

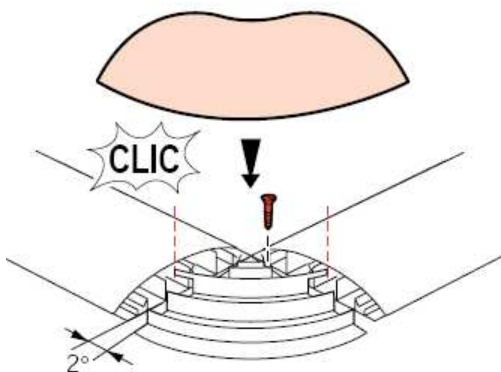

2. FINISHING ACCESSORIES (continued)

2.2. Cover joint, Cat. Nos 030011/19 and 032803

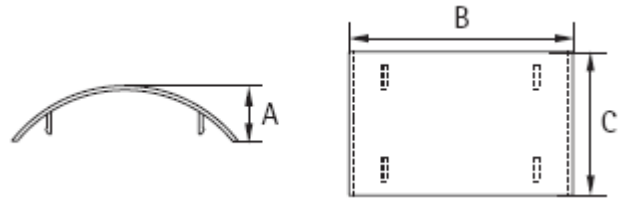

References	For cover joint	Dimensions in mm
030012	50x12 mm	A=14/B=52/C=50
030019	75x18 mm	A=19/B=78/C=50
032803	92x20 mm	A=B=C=

For end-to-end joining of two pieces of cover of the same cross-section:

- compliance with the protection index
- improved styling (cut covered)
- mounting on skirting by snap-fitting

Colour, grey RAL 7030 for Cat. Nos 030012/19

Colour, grey RAL 7016 for Cat. No. 032803

Packs of 10

For mounting with floor ducts 50x12 or 75x18mm

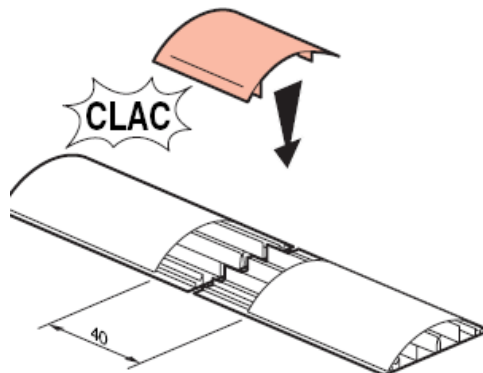

For mounting with floor ducts 92x20mm

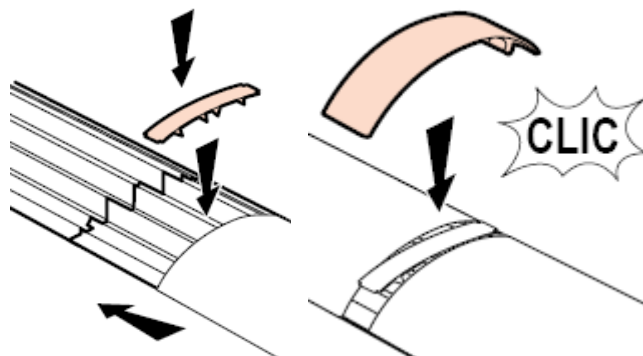

2. FINISHING ACCESSORIES (continued)

2.3. Junction box, Cat. Nos 030013 and 032801.



For routing in 4 directions with voltage separation for floor ducts of the same cross-section:

- compliance with the protection index
- improved styling (cut covered)
- screwed floor mounting

Colour, grey RAL 7030 for Cat. No. 030013
Colour, grey RAL 7016 for Cat. No. 032801
Packs of 4 for Cat. No. 030013, packs of 5 for Cat. No. 032802

Overall dimensions:

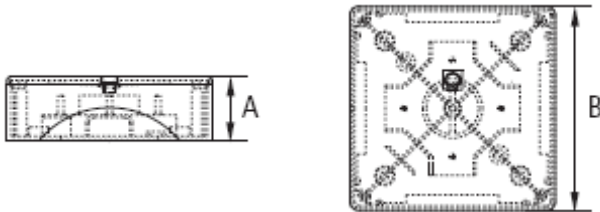

Dimensions :

References	Junction box for floor duct	Dimensions en mm
030013	50x12 mm and 75x18mm	A=34/B=110
032802	92x20 mm	A=40/B=178

2.4. End cap, Cat. No. 032807

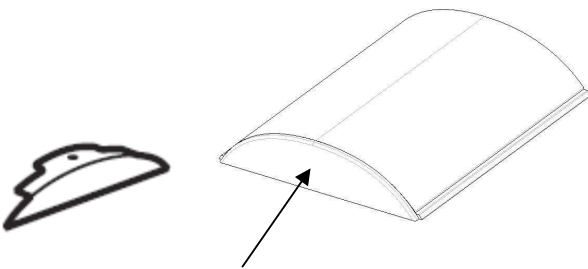

For blanking the end of the floor duct, Cat. No. 032800
- compliance with the protection index
- improved styling
Packs of 10

Mounting on profile body from front, by fitting-in and screwing.

Note, no end cap references for floor ducts 50x12 and 75x18mm

Colour, grey RAL 7016

2. FINISHING ACCESSORIES (continued)

2.5. Connection for skirting mounted mini-trunking 60x20/75x20 mm
Cat. No. 032805

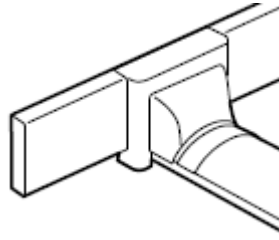

For branching from mini-trunking 60x20/75x20 mm to floor duct Cat. No. 032800

- compliance with the protection index
- improved styling (cut covered)
- mounting on profile by snap-fitting
- Colour, white RAL 9003
- Packs of 1

2.6. Connection for white skirting-trunking 80/120x20 mm Cat. No. 032806

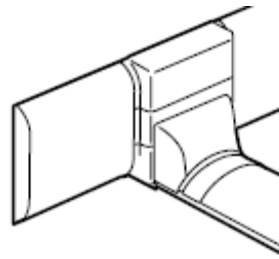

For branching from skirting-trunking 80/120x20 mm to floor duct
Cat. No. 032800

- compliance with the protection index
- improved styling (cut covered)
- mounting on profile by snap-fitting
- Colour, white RAL 9003
- Packs of 1

2.7. Connection for skirting-trunking 140x35 mm Cat. No. 032810

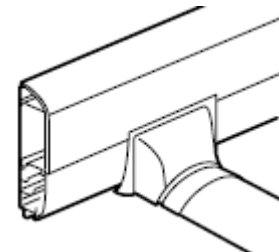

For branching from skirting-trunking 140x35 mm to floor duct Cat. No. 032800

- compliance with the protection index
- improved styling (cut covered)
- mounting on profile by snap-fitting
- Colour, white RAL 9003
- Packs of 1

2. FINISHING ACCESSORIES (continued)

2.8. Branch to floor duct Cat. No. 010770/71/72/74

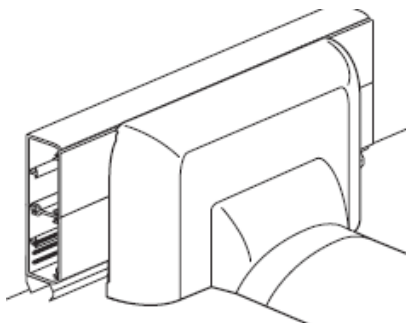

For branching from DLP trunking to floor duct Cat. No. 032800

- compliance with the protection index
 - improved styling (cut covered)
 - mounting on profile by snap-fitting
 - Colour, white RAL 9003
- Packs of 5

For use from DLP to floor duct:

Branches to floor duct Cat. Nos 010770/71/72/74 must be combined with floor duct extra Cat. No. 010690 (see below)

2.9. Floor duct DLP extra Cat. No. 010690.



For completing the branching from DLP trunking to floor duct Cat. No. 032800

- compliance with the protection index
 - improved styling (cut covered)
 - mounting on profile by snap-fitting
 - Colour, white RAL 9003
- Packs of 5

3. IMPLEMENTATION

3.1. Connection from mini-column Cat. No. 030742 to floor duct Cat. No. 032800

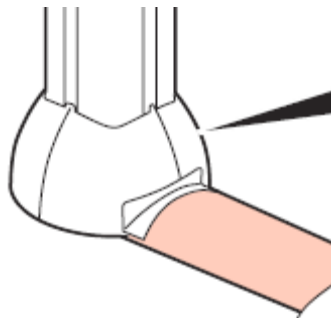

A mini-column can be connected to a floor duct Cat. No. 032800.

- compliance with the protection index
- improved styling (cut covered)
- mounting on mini-column cover by fitting-in
- Colour, white RAL 9003

(the mini-column is supplied with the floor duct adapter)



3.2. Connection of floor unit Cat. No. 031748/49 to floor duct Cat. No. 032800

A floor unit can be connected to a floor duct Cat. No. 032800.

Floor unit in single use:

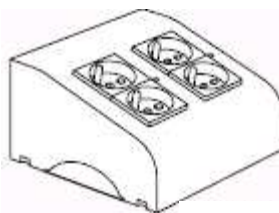

Floor unit combined with floor duct:

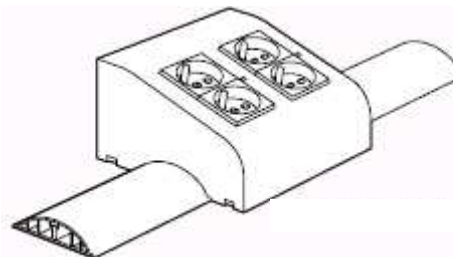

4. TECHNICAL CHARACTERISTICS.

Classification for distribution system by floor standard NF EN 50085-2-2 concerns systems for distributing currents in the floor (sunken or surface-mounted)

		On floor
6.2	Resistance to impact for installation and application	5 J
6.3	Minimum storage and transport temperature	- 25 °C
6.3	Minimum installation and application temperature	- 5 °C
6.3	Maximum application temperature	+ 60 °C
6.4	Resistance to flame propagation	Non propagating
6.5	Electrical continuity characteristics	Without continuity
6.6	Electrical insulating characteristics	Without electrical insulating characteristic
6.7	Degree of protection provided by enclosure	IP20
6.9	System access cover retention	With a tool
6.101	Floor treatment	Dry floor treatment
6.102	Resistance to a vertical load applied over a small surface area	750 N
6.103	Optional classification according to resistance to a vertical load applied over a large surface area	3000 N

Composition and function with distribution system on floor.

Dim. trunking	92 x 20 Cat.No 328 00
Nbr of compartments	4
Accessories for over floor trunking	Distribution box Cat.No 328 01
	Flat angle Cat.No 328 02
	Cover joint Cat.No 328 03
	End cap Cat.No 328 07
Mini-column	White Cat.No 307 42
	Alu Cat.No 307 29
Column modules	see p. 788-789

5. MATERIAL CHARACTERISTICS.

For accessories (flat angles, end caps, junction boxes, cover joints, branches, adapters, extras)

Family: polyvinyl chloride PVC

For floor duct

Family: polyvinyl chloride PVC

Material PVC RAL 7030 For ref 30092 and 30093

Material PVC RAL 7016 For ref 32800